

DO NOT SCALE FROM THIS DRAWING FOR CONSTRUCTION PURPOSES

THIS COPY HAS BEEN MADE BY OR WITH THE AUTHORITY OF RYEDALE DISTRICT COUNCIL PURSUANT TO SECTION 47 OF THE COPYRIGHT DESIGNS AND PATENTS ACT 1988. UNLESS THAT ACT PROVIDES A RELEVANT EXCEPTION TO COPYRIGHT, THE COPY MUST NOT BE COPIED WITHOUT THE PRIOR PERMISSION OF THE COPYRIGHT OWNER.

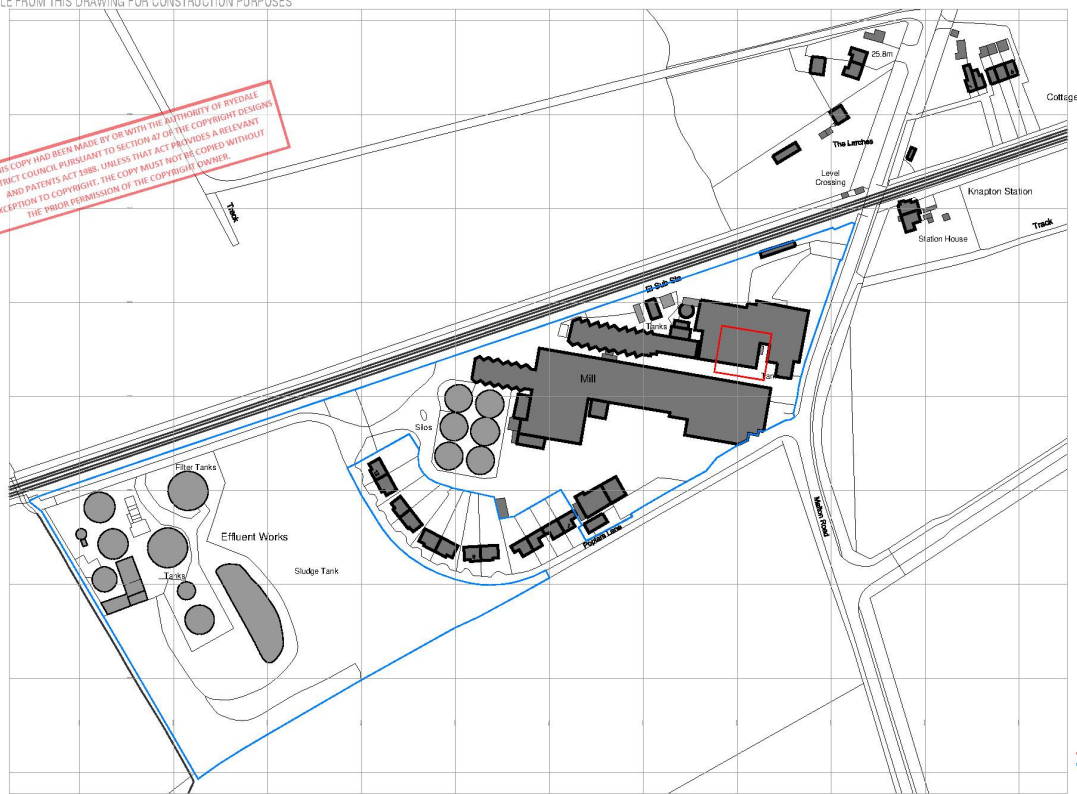

DATE VALID
02/04/15

General Notes

Site boundary: 47539 1m² (approx)
Secondary boundary: 11.75 acres, 4.75 hectare

General Arrangement _ Os Map _ 1 : 2500

Status: PLANNING		Job Title: Location / Os Map	Map Title: Boortmalt Group Knapton Maltings, Knapton Malton, North Yorkshire, YO17 6RN Roaster Project	Client: BOORTMALT	Client: Gelder and Kitchen LLP CONSTRUCTION CONSULTANTS Malton House, 100 High Street, Knapton Open Hall, YO1 1RL T: +44 (0)1902 204114 www.gelderandkitchen.co.uk
Job No: 13/209	Drawn: AA	Checked: 100	Date: 001	Date: 25/04/15	Drawn by: RMR
Scale: 1 : 2500		Date: 25/04/15			